



INTAKE SYSTEMS FOR VEHICLES LISTED ARE 50 STATE LEGAL. SEE KNFILTERS.COM FOR CARB STATUS ON EACH PART FOR A SPECIFIC VEHICLE.

INSTALLATION INSTRUCTIONS

**57-3100
CADILLAC
2016-17 ATS
L4-2.0L Turbo**

TOOLS NEEDED:

- Ratchet
- Extension
- 10mm socket
- T20 torx
- 4mm allen
- 3mm allen
- Flat Blade screw driver

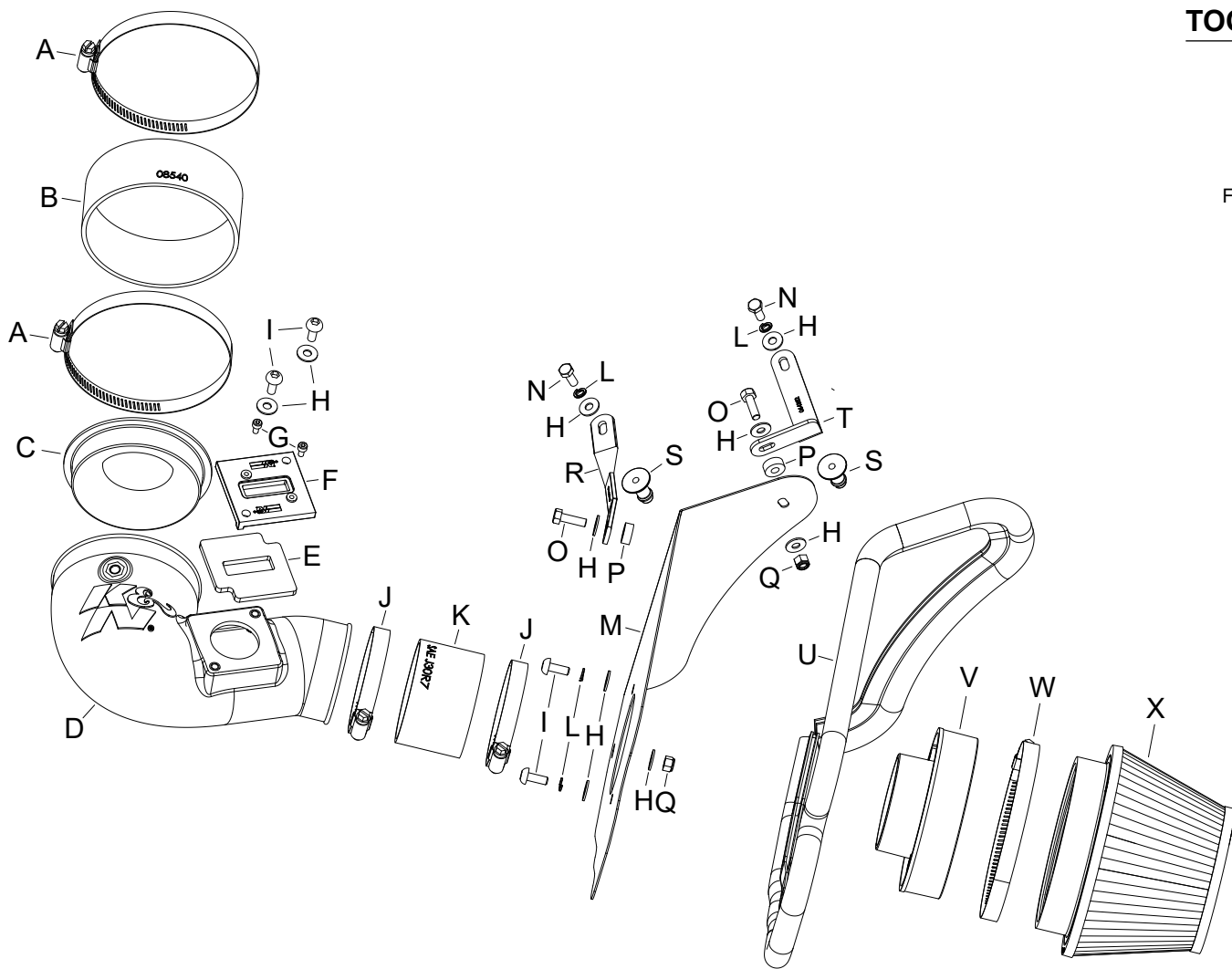

PARTS LIST:

Description	Qty.	Part #	Description	Qty.	Part #	Description	Qty.	Part #
A HOSE CLAMP #72	2	08671	I BOLT; M6 X 1 X 16MM	4	07730	Q NUT; 6MM NYLOCK	2	07512
B HOSE; 4.5" ID X 1.75" L	1	08540	J HOSE CLAMP #48	2	08601	R BRACKET; TWIST	1	064349
C VENTURI; TUBE INSERT	1	088026	K HOSE; 3" ID X 2" L REIN.	1	08711	S MOUNT, PLASTIC AIRBOX	2	8-186-1
D INTAKE TUBE (MB)	1	087354A	L WASHER, M6 SPLIT LOCK ZINC	4	1-3025	T BRACKET; "L"	1	064352
E GASKET; 3/16 PORON	1	09069	M HEAT SHIELD	1	073250	U EDGE TRIM (44")	1	102486A
F ADAPTOR; NYLON 6/6	1	21515-1	N BOLT; M6-1 X 16MM	2	07812	V ADAPTER; FILTER, 3.0"OD	1	21569
G BOLT; M4 - .7 X 8MM	2	07733	O BOLT; M6 X 1 X 20MM	2	07795	W HOSE CLAMP; #80	1	08694
H WASHER; 6MM FLAT	10	08269	P SPACER: .625" OD X .250"ID	2	06555	X AIR FILTER	1	RU-5163XD

If you need any assistance please call 1-800-858-3333 to speak with a representative in our Customer Service Center before returning the product.

NOTE: FAILURE TO FOLLOW INSTALLATION INSTRUCTIONS AND NOT USING THE PROVIDED HARDWARE MAY DAMAGE THE INTAKE TUBE, THROTTLE BODY AND ENGINE.

TO START:

1. Turn off the ignition and disconnect the negative battery cable.

NOTE: Disconnecting the negative battery cable erases pre-programmed electronic memories. Write down all memory settings before disconnecting the negative battery cable. Some radios will require an anti-theft code to be entered after the battery is reconnected. The anti-theft code is typically supplied with your owner's manual. In the event your vehicles anti-theft code cannot be recovered, contact an authorized dealership to obtain your vehicles anti-theft code.



2. Release the locking tab and then disconnect the mass air sensor electrical connection and unhook the wiring harness from the intake tube.



3. Loosen the hose clamp that secures the factory intake tube to the turbo inlet chamber.



4. Lift the complete factory intake assembly up to dislodge it from the mounting grommets and then remove it from the vehicle.



5. Install the provided edge trim onto the heat shield as shown.

NOTE: Some trimming of the edge trim will be necessary.



6. Install the radius filter adapter into the heat shield and secure with the provided hardware.



7. Install the two provided mounting studs onto the mounting brackets and secure with the provided hardware.



8. Install the mounting bracket assemblies onto the heat shield as shown and secure with the provided hardware.



9. Install the K&N® air filter onto the filter adapter and secure with the provided hardware.



10. Install the heat shield assembly into the vehicle so that the mounting studs insert into the factory air box mounting grommets.



11. Install the provided coupler hose (08711) onto the filter adapter and secure with the provided hose clamp.



12. Install the provided coupler hose (08540) onto the turbo inlet chamber and secure with the provided hose clamp.



13. Install the provided gasket onto the mass air sensor adapter.



14. Remove the mass air sensor from the factory air filter housing.



15. Install the mass air sensor into the K&N® mass air sensor adapter and secure with the provided hardware.



16. Install the mass air sensor assembly into the K&N® intake tube as shown with the opening of the sensor towards the inlet of the intake tube. Secure the assembly with the provided hardware.



17. Install the air diverter into the K&N® intake tube so that the radius face is inside the intake tube.



18. Install the K&N® intake tube into the hose at the filter adapter and then into the hose at the turbo chamber, adjust the tube for best fit and then secure with the provided hose clamps.



19. Reconnect the mass air sensor electrical connection and secure the wiring harness to the insert in the K&N® intake tube.

NOTE: It may be necessary to release some of the electrical tape from the mass air sensor pigtail to main harness to increase the wiring slack and prevent the wiring harness to be pulled tight.



20. Reconnect the vehicle's negative battery cable. Double check to make sure everything is tight and properly positioned before starting the vehicle.

21. The C.A.R.B. exemption sticker, (attached), must be visible under the hood so that an emissions inspector can see it when the vehicle is required to be tested for emissions. California requires testing every two years, other states may vary.

22. It will be necessary for all K&N® high flow intake systems to be checked periodically for realignment, clearance and tightening of all connections. Failure to follow the above instructions or proper maintenance may void warranty.

ROAD TESTING:

1. Start the engine with the transmission in neutral or park, and the parking brake engaged. Listen for air leaks or odd noises. For air leaks secure hoses and connections. For odd noises, find cause and repair before proceeding. This kit will function identically to the factory system except for being louder and much more responsive.

2. Test drive the vehicle. Listen for odd noises or rattles and fix as necessary.

3. If road test is fine, you can now enjoy the added power and performance from your kit.

4. K&N Engineering, Inc., requires cleaning the intake system's air filter element every 100,000 miles. When used in dusty or off-road environments, our filters will require cleaning more often. We recommend that you visually inspect your filter once every 25,000 miles to determine if the screen is still visible. When the screen is no longer visible some place on the filter element, it is time to clean it. To clean and re-oil, purchase our filter Recharger® service kit, part number 99-5050 or 99-5000 and follow the easy instructions.

INTAKE SYSTEMS FOR VEHICLES LISTED ARE 50 STATE LEGAL. SEE KNFILTERS.COM FOR CARB STATUS ON EACH PART FOR A SPECIFIC VEHICLE.